

HOME of
KITCHENS



Kitchen Design Guide

Proudly Manufactured in Australia by:



Affordable Quality Solutions

A.B.N. 123 802 496 75

A.C.N. 099 040 865

MON - FRI 8am - 5.30pm

SAT 9am - 4pm

SUN Closed

222-224 Frankston-Dandenong Rd

Dandenong South VIC 3175

Phone: (03) 9793 4233

Fax: (03) 9792 5046

E: info@homeofkitchens.com.au

W: www.homeofkitchens.com.au



TABLE OF CONTENTS

[PAGE 2](#) Starting out your Kitchen Design
* Something to think about before you start
* Helpful hints...

[PAGE 3](#) Setting your Kitchen
* Measure the kitchen area
* Where to start?...

[PAGE 4](#) Sample Room Measurement Guide
* Measurement in millimeters
* Key points to consider

[PAGE 5-9](#) Component Units
* Standard Flatpacks
* Different types of Wall Ovens Units...

[PAGE 10](#) Cabinet Heights

[PAGE 11](#) Instructions on kicker legs
* Diagram of how to screw your plastic legs

[PAGE 12-13](#) Final Sample Design Layout

[PAGE 14](#) Start your own Design (Design Sheet)

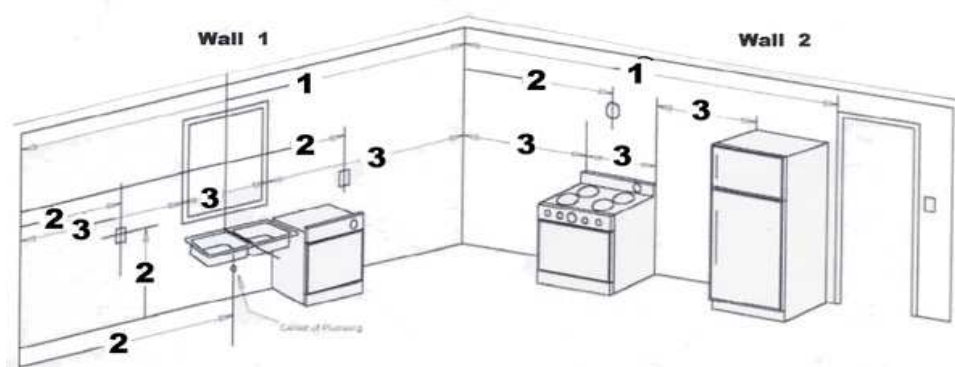



KITCHEN DESIGN

Something to think about before you start?
Consider the following points:

- How many people need to be catered for?
- How much storage space is required?
- Do you intend eating in the kitchen?
- What type of food do you need to prepare?
- What type of appliances will you have?
- How much work area do you need?
- Traffic Flow

The following cabinets are essential in a kitchen design:

SINK CABINET

Ensure that your sink bowls fit between the walls of your cabinet. Cabinets 555 Deep are standard to suit flush sinks.

DRAWERS

Try to keep away from corners to avoid handles clashing.

PANTRY

How often do you shop, if you bulk buy you will need larger than normal storage?

FRIDGE

Is your fridge big enough? Which hand does it open?
Do you need a cabinet above?

COOKTOP / RANGEHOOD

Is your cooktop gas or electric and are you having a rangehood above? Remember the minimum height clearances of your rangehood, electric is approximately 600mm while gas is approximately 650mm. All these sizes will need to be checked for exact regulations with the appliance manufacturer and council specifications.

OVEN

Are you having an underbench oven under the cooktop, or do you have enough room for a wall oven? If you have an upright stove ensure that you leave a gap of 4mm clearance to the benchtop on each side.

DISHWASHER

Are you having a dishwasher? Allow a 605 clearance and panels/infills either side. The dishwasher should be located as close to the sink as possible.

All sizes of appliances and installation requirements should be ascertained before designing your new kitchen. Check with your local council about the requirements of some kitchen installations.

What goes where? Some helpful hints:

The position of your appliances will depend mainly on your power and water supply. The sink and dishwasher will need water and waste supply and is usually best situated under windows.

It is best to leave the area above the sink free of any wall cabinets.

Gas hotplates and ovens should be kept near the gas supply the other appliances such as the oven, hotplate, rangehood, microwave and fridge all need a power supply. Thought should be given to where power points are to be located above the bench for small appliances such as electric kettles and toasters.

It will be more economical if all these appliances can be left near their supplies, but do not feel that you are tied to these positions permanently. Gas lines and electrical supplies can be moved to a much user-friendly spot but these can only be moved by licensed tradespersons.

All tall units such as pantries, wall ovens and fridge towers should be kept together. There has to be a space of 300mm between the hot plate /stove and a combustible wall. Stoves and hotplates should not be placed in front of windows where draughts can effect their efficiency and where curtains or blinds can be set alight.

Make sure that the rangehood cabinet is directly above the stove/hotplate for maximum efficiency.

When using a sink with a draining board remember to put the draining board on the side you're most comfortable, depending on what hand you are. If you are having a dishwasher, the dishwasher would normally sit above it.

Remember to allow enough space for door openings, such as dishwasher, oven, pantries and kitchen entry doors. Also allow enough space for the amount of people to use the kitchen and walk around safely.

Microwaves should not be any higher than shoulder height of the person that is the primary user of the kitchen.

Finally the kitchen has to be practical as well as being efficient, you will need to think carefully about the layout of your new kitchen, and once it is up and running it should be a pleasure to work in.

SETTING OUT YOUR NEW KITCHEN.

When assessing the requirements for your new kitchen take the time to write a few notes about what you like and do not like about your current kitchen.

First make a rough plan of what you would like to do on a separate piece of paper.

Study the brochures on any new appliances you propose to use, but do not make any firm decision at this stage because in many cases the available space will dictate what appliances you can use.

Measure the Kitchen Area:

You are now ready to design and measure your kitchen. When measuring your kitchen remember to measure to the nearest **millimetre**, always use a pencil in case of mistakes, and always double check your measurements or get a friend to check them with you.

Where to Start?

Select your starting point and call this wall #1. And then work your way around to the right.

WALLS

Measure each wall starting at # 1, the measurement should be taken at a height of 900mm off the floor level, this will be the bench top height. Now measure the height of the wall, if a bulkhead exists measure from the floor to the underside of the bulkhead and then measure the height of the bulkhead to give an overall room height.

DOORS

It is important to note the width of each door; the measurement should include the architrave on each side of the door. Take the measurement from the corner of the kitchen to the edge of the architrave and do the same from the other side of the architrave to the next corner.

WINDOWS

It is the same for the windows but take the height the window is off the floor and then the overall height of the window.

HANDY HINT

To ensure the above measurements are correct, firstly note the overall width of the wall. Then separately measure the door width and the widths on each side of the door these should tally and match your overall width.

PLUMBING

To locate the plumbing on your layout measure the distance from the left-hand corner to the centre of the outlet pipe under the sink, the same can be done for tap fittings as well as the gas line.

ELECTRICAL

To locate the power points or light switches on your layout measure the distance from the left-hand corner of the wall. The height of the power points and switches from the floor should also be noted.

APPLIANCES

The type of appliances can affect the layout of your kitchen. Please list your choice of appliances, noting which are gas, in the space provided on your layout grid. Remember to list all of your appliances. Eg: refrigerator, stove, wall oven, hotplate, sink, (bowl size), microwave, dishwasher, range hood, and any other speciality appliance that is needed.

OTHER

If there is any other features that will influence the design of your kitchen, such as heater vents make sure that these are noted on the plan.

CABINETS

Before positioning any cabinets your plan should feature any or all of the above items.

Door styles and types can also dictate the size of cabinets used. Some timber doors can not be made under 300mm wide. Also there is some restrictions on minimum and maximum heights.

Decorative panels and infills can also have bearing on the overall size of your kitchen. Remember that on the end of some of the cabinets you will need a decorative end panel, the bench top will then usually overhang by about 20mm.

By looking through our cabinet catalogue you'll see that most of our cabinets are made up from modules starting at 300mm increasing up to 1200mm in width; it merely requires you to select the required cabinets to suit your design. But remember these standard sizes can be modified at little or no extra cost so your cabinets fit perfectly into your space without the need for fillers. Can't find the cabinet you want? Then it can be made to suit your need.

Of course your room is unlikely to be an exact multiple of 100mm and your walls cannot be relied on to be even or square, so for the purpose of designing your own kitchen, pick cabinets out to the closest 100mm under size so a filler can be used to make up the required space.

Using the right code.

We have over 70 cabinets that can help you construct your new kitchen. You will see the codes and sizes on the cabinet production list. If you need more information on any of the cabinets, look through the cabinet description to follow:

In our catalogue you will notice that each cabinet has it's own code. A base cabinet that is 600mm wide is called a **BD 600**, **BD** standing for base deep.



SAMPLE ROOM MEASUREMENT GUIDE

ALL MEASUREMENTS MUST BE IN MILLIMETERS.

SHOULD YOU HAVE ANY DIFFICULTIES, CONTACT OUR SALES STAFF FOR ASSISTANCE.

KEY	
☆	SINK WASTE
●	POWER OUTLET
△	WATER SUPPLY
☀	GAS SUPPLY

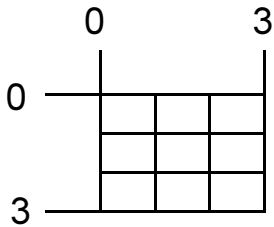

Starting point on Grid Sheet.

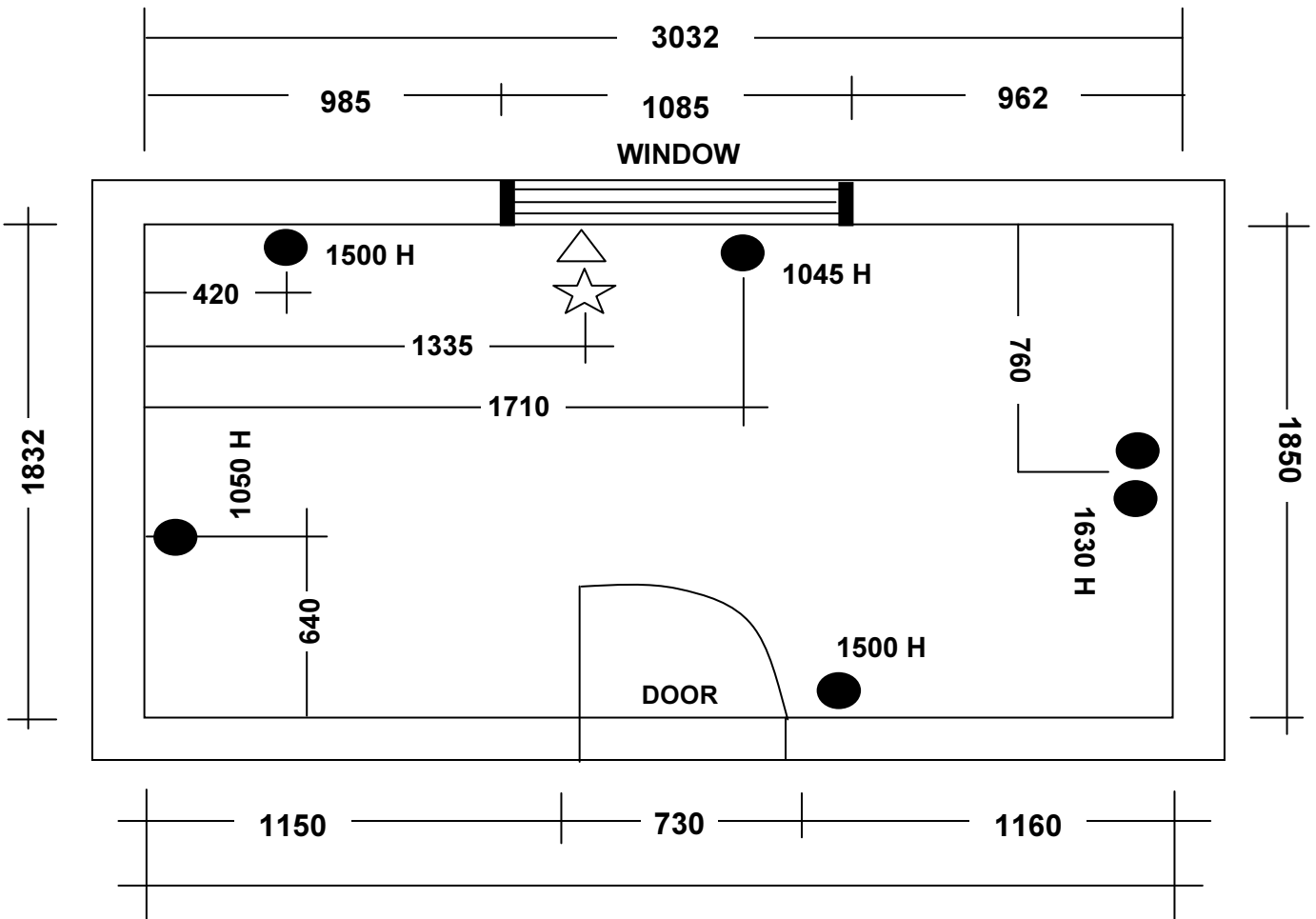

Kitchen Component List

FLOOR UNITS

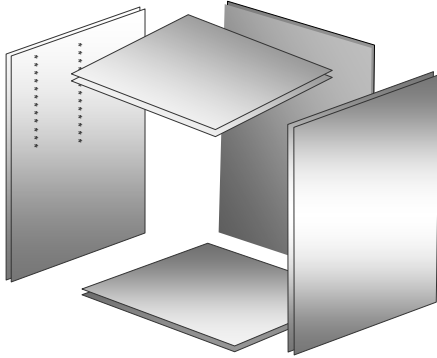

Base Cabinet		Door	
Code	Size H x W x D	QTY	Size H x W
BD300	720 x 300 x 555	1	717 x 297
BD400	720 x 400 x 555	1	717 x 397
BD450	720 x 450 x 555	1	717 x 447
BD500	720 x 500 x 555	1	717 x 497
BD600	720 x 600 x 555	2	717 x 297
BD700	720 x 700 x 555	2	717 x 347
BD800	720 x 800 x 555	2	717 x 397
BD900	720 x 900 x 555	2	717 x 447
BD1000	720 x 1000 x 555	2	717 x 497
BD1100	720 x 1100 x 555	2	717 x 547
BD1200	720 x 1200 x 555	2	717 x 597

WALL UNITS

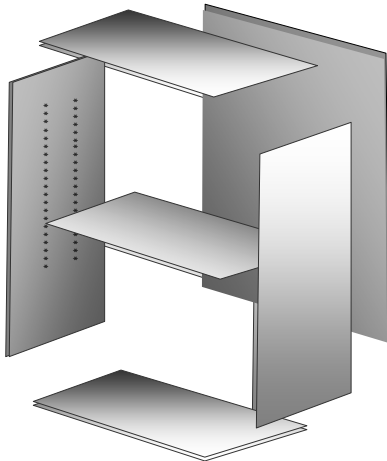

Wall Cabinet		Door	
Code	Size H x W x D	QTY	Size H x W
WT300	720 x 300 x 300	1	717 x 297
WT400	720 x 400 x 300	1	717 x 397
WT450	720 x 450 x 300	1	717 x 447
WT500	720 x 500 x 300	1	717 x 497
WT600	720 x 600 x 300	2	717 x 297
WT700	720 x 700 x 300	2	717 x 347
WT800	720 x 800 x 300	2	717 x 397
WT900	720 x 900 x 300	2	717 x 447
WT1000	720 x 1000 x 300	2	717 x 497
WT1100	720 x 1100 x 300	2	717 x 547
WT1200	720 x 1200 x 300	2	717 x 597

BROOM UNITS

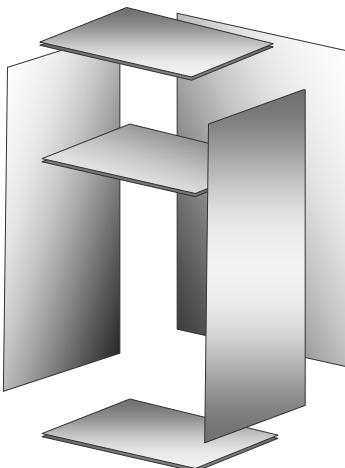

Broom Cabinet		Door	
Code	Size H x W x D	QTY	Size H x W
BR600	2125 x 600 x 575	2	2122 x 297
BR700	2125 x 700 x 575	2	2122 x 347
BR800	2125 x 800 x 575	2	2122 x 397
BR900	2125 x 900 x 575	2	2122 x 447
BR1000	2125 x 1000 x 575	2	2122 x 497

PANTRY UNITS

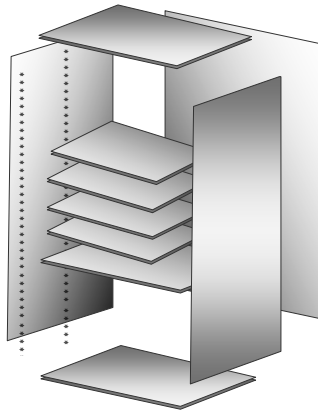

Pantry Cabinet		Door	
Code	Size H x W x D	QTY	Size H x W
PD600	2125 x 600 x 575	2	2122 x 297
PD700	2125 x 700 x 575	2	2122 x 347
PD800	2125 x 800 x 575	2	2122 x 397
PD900	2125 x 900 x 575	2	2122 x 447
PD1000	2125 x 1000 x 575	2	2122 x 497

APPLIANCE PANTRY UNITS

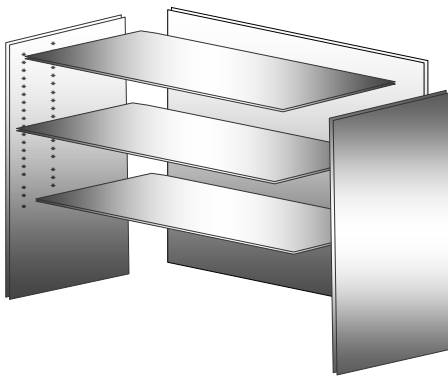

Appliance Pantry Cabinet		Door	
Code	Size H x W x D	QTY	Size H x W
APP450	1370 x 450 x 400	1	1367 x 447
APP600	1370 x 600 x 400	2	1367 x 297
APP700	1370 x 700 x 400	4	1367 x 172
APP800	1370 x 800 x 400	4	1367 x 197
APP900	1370 x 900 x 400	4	1367 x 222

RANGEHOOD & FRIDGE UNITS

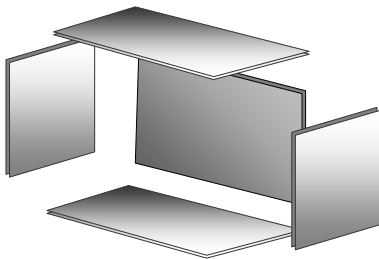

Rangehood & Fridge Cabinet		Door	
Code	Size H x W x D	QTY	Size H x W
WS600	360 x 600 x 300	2	357 x 297
WS700	360 x 700 x 300	2	357 x 347
WS800	360 x 800 x 300	2	357 x 397
WS900	360 x 900 x 300	2	357 x 447
WS1000	360 x 1000 x 300	2	357 x 497

WALK IN CORNER PANTRY UNITS

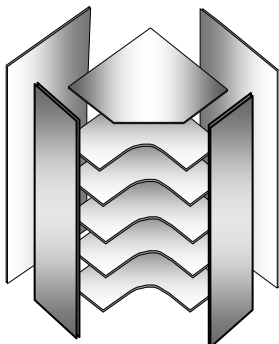

Walk in Corner Pantry Cabinet		Door	
Code	Size H x W x D	QTY	Size H x W
PCNR1000	2270 x 1000 x 585	1	2255 x 560

POT DRAWER UNITS

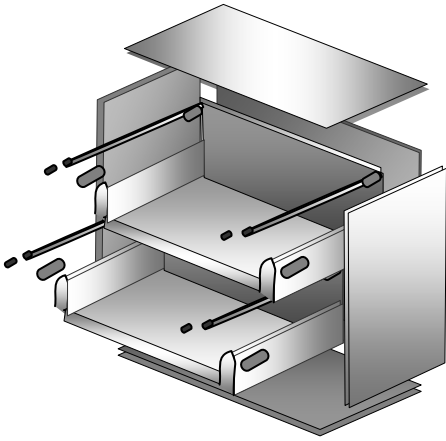

1, 2 and 3 Pot Drawer Cabinet's		Drawer Front	
Code	Size H x W x D	QTY	Size H x W
PDRIN1600	360 x 600 x 555	1	357 x 597
PDRIN1900	360 x 900 x 555	1	357 x 897
PDRIN600	720 x 600 x 555	2	357 x 597
PDRIN700	720 x 700 x 555	2	357 x 697
PDRIN800	720 x 800 x 555	2	357 x 797
PDRIN900	720 x 900 x 555	2	357 x 897
PDRIN3600	720 x 600 x 555	3	237 x 597
PDRIN3700	720 x 700 x 555	3	237 x 697
PDRIN3800	720 x 800 x 555	3	237 x 797
PDRIN3900	720 x 900 x 555	3	237 x 897

CUTLERY DRAWER UNITS

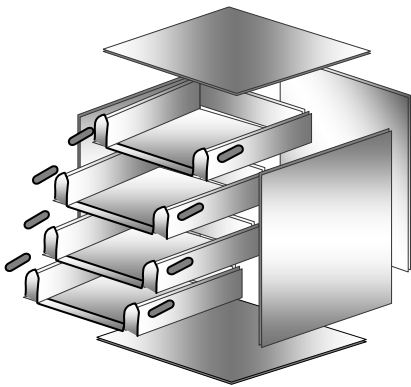

Cutlery Drawer Cabinet		Drawer Fronts	
Code	Size H x W x D	QTY	Size H x W
DDRIN400	720 x 400 x 555	4	177 x 397
DDRIN450	720 x 450 x 555	4	177 x 447
DDRIN500	720 x 500 x 555	4	177 x 497

WALL BIFOLD CORNER UNITS

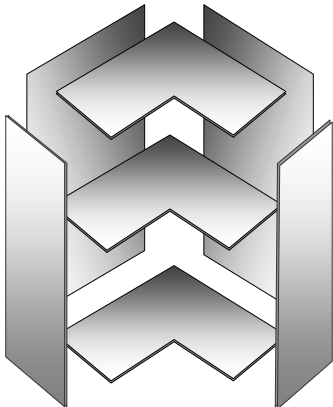

Wall Bifold Corner Cabinet		Door		
Code	Size H x W x D	QTY	Size H x W	16/18/20mm
WTC600	720 x 600 x 300	2	717 x 277	16
WTC600	720 x 600 x 300	2	717 x 276	18
WTC600	720 x 600 x 300	2	717 x 275	20

FLOOR BIFOLD CORNER UNITS

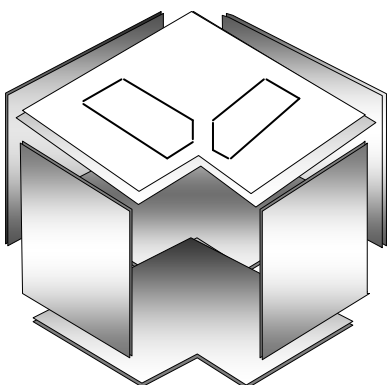

Floor Bifold Corner Cabinet		Door		
Code	Size H x W x D	QTY	Size H x W	16/18/20mm
BCD880	720 x 880 x 555	2	717 x 304	16
BCD880	720 x 880 x 555	2	717 x 302	18
BCD880	720 x 880 x 555	2	717 x 300	20

WALLOVEN UNITS

Waloven Units are 2270mm high and can be either 600 or 700mm wide.

The style in which it is made can be up to you to suit your kitchen needs.

Below are three options (A,B,C) you can choose from. When ordering a Waloven unit make sure you specify the style .

Waloven Cabinet		Door	
Code	Size H x W x D	QTY	Size H x W
TOWER600	2270 x 600 x 575	2	ASK x 297
TOWER700	2270 x 700 x 575	2	ASK x 347

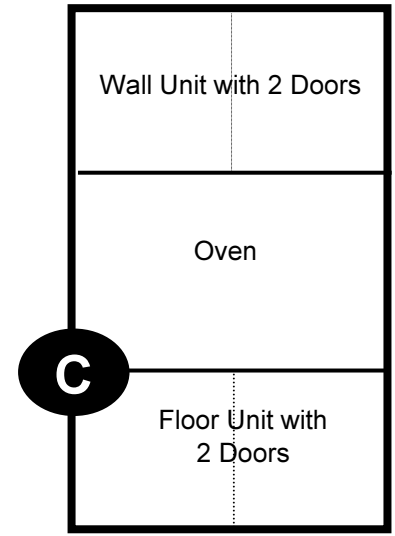
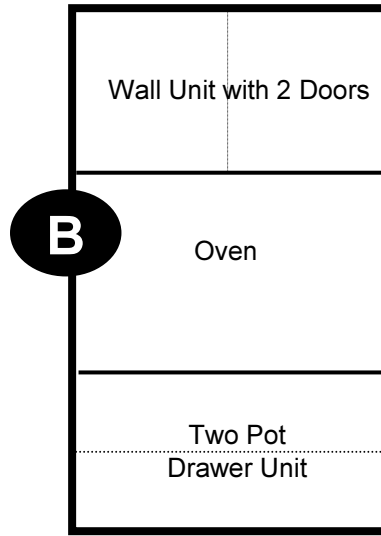
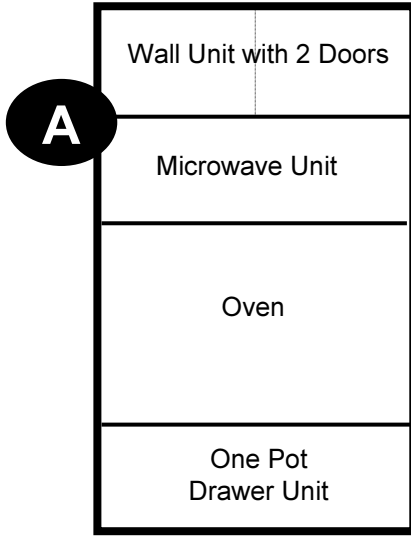

MICROWAVE SHELF UNITS

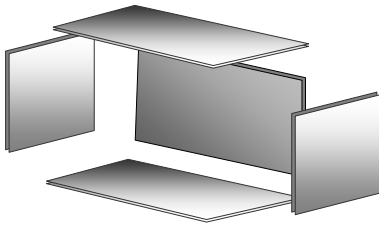

Microwave Shelf Cabinet	
Code	Size H x W x D
MW600	400 x 600 x 450
MW700	400 x 700 x 450

DISPLAY UNITS

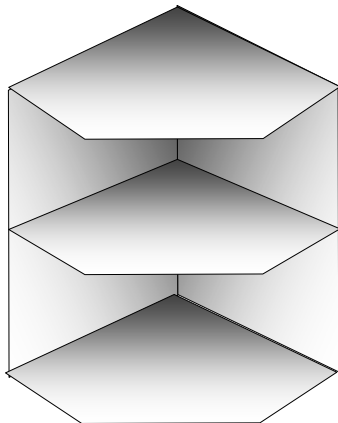

OPEN CORNER WALL UNITS

Open Corner Wall Cabinet	
Code	Size H x W x D
WOS300	720 x 300 x 320

OPEN CORNER FLOOR UNITS

Open Corner Floor Cabinet	
Code	Size H x W x D
BOS300	720 x 300 x 575

PANELS AND INFILLS.

On the end of your cabinets you may need a decorative end panel. This will hide the white cabinet and cover the gap made by the kicker. These panels can be made in the same finish as the doors.

Kickboards come in a standard size of 2400mm long and 145mm high. They are supplied in a long length so you can cut them to the size required. The code for the kickboards is KICKRAIL.

The bulkhead is a panel that sits above the wall cupboards between the cupboards and the ceiling to fill in that space if desired. The bulkhead width is solely dependant on the ceiling height and the standard size is 2400mm long and 285mm high **TO BE CUT ON SITE..** The code for the bulkhead is BULKHEAD.

At the top of the overhead cabinets you can fit a decorative capping mould, which can be supplied in several different finishes. Capping mould is supplied in long lengths, which you can cut to the required size. The code for the capping is CAP MOULD.

Each base cabinet regardless of their depth requires 4 adjustable legs which can be adjusted to keep your cabinets level.

The adjustable legs installation details is included in this manual.

There is a large range of hardware accessories available, which include many types of rubbish bins, wirebaskets, cutlery trays, carousels, and pull out pantry units and towel rails. All of the fittings are optional extras, and they may be fitted in your cabinets at the time of construction or later.

DOORS:

We can supply a large range of different door types, which include;

SQUARE EDGE MELAMINE.

Square-edged melamine is available in a vast range of colours and woodgrain finishes and edged in 1mm or 2mm polyvinyl chloride (PVC).

M.D.F (Medium density fibre-board)

Square-edged MDF is available in flat panel or standard routed door. Doors can be painted with the colour of your choice. We suggest a two-pac finish, which consists of paint and hardener; the two are mixed together to form a strong, hard-wearing 'two-pack' solution. This is available in a range of gloss levels and provides a very stylish finish.

HARDFORM (Round edge doors)

Hardform doors come in two profiles which are "L" or "U". There are many colours within the range to choose from. Once again the doors come complete with their hinges and a choice of handles.

NATURAL TIMBER VENEER.

Natural timber veneer has a large range of different species of veneer. All doors and drawers are edged all round.

VINYL. (Vacuum formed doors)

There are 21 different designs and 18 different colours to choose from. The hinges and your choice of handle come with each door.

TIMBER

Solid timber doors including Tasmanian Oak, Tasmanian Blackwood, Jarrah, American white oak and Radiata pine

Just to name a few, there are various styles in each species. We supply the doors in their raw or polished state.

GLASS

Aluminium-framed glass doors enable you create highlights or display features in your custom kitchen. Choose from different profiles and colours and couple with glass shelves to create that point of difference.

Please note that true door styles, samples and colours can be seen on display in our kitchen showroom.

BENCHTOPS:

There are many beautiful materials available for creating the perfect benchtop. Whether you want something strictly functional or are looking to make a statement, Home of Kitchens can provide you with the benchtop of your choice

If you decide to have a laminate top you have the choice of many different colours and textures and edge treatments, (such as front edge post-formed in 180 or 90 degree.)

You can give your kitchen a country look by having a solid timber benchtop. There is a large range of different timber species that can be catered for. All solid timber tops come raw, but can be polished.

Alternatively you may wish to use a stone, granite or similar product. The choice to make with a stone benchtop is whether to go with a natural stone or an engineered stone. Granite is one of the most popular choices of natural stone used for benchtops. Engineered stone benchtops consist of about 95 per cent quartz and 5 per cent polymer resins and colouring. Granite and quartz are resistant to weathering so should not chip, scratch or stain. Engineered stone can be installed in a 20mm or 40mm thickness and with a waterfall edge.



Standard Kit Carcase Heights and Depths

Front View

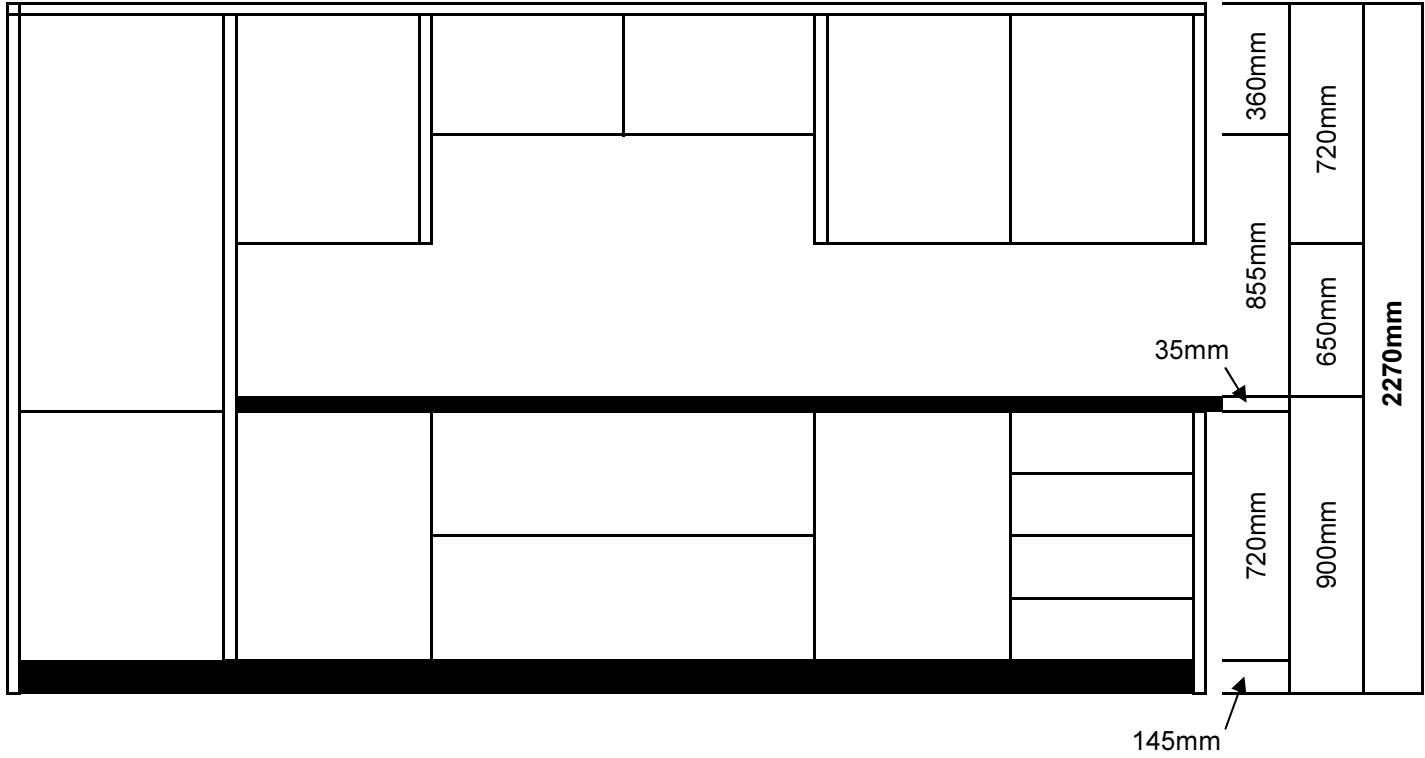

Side View

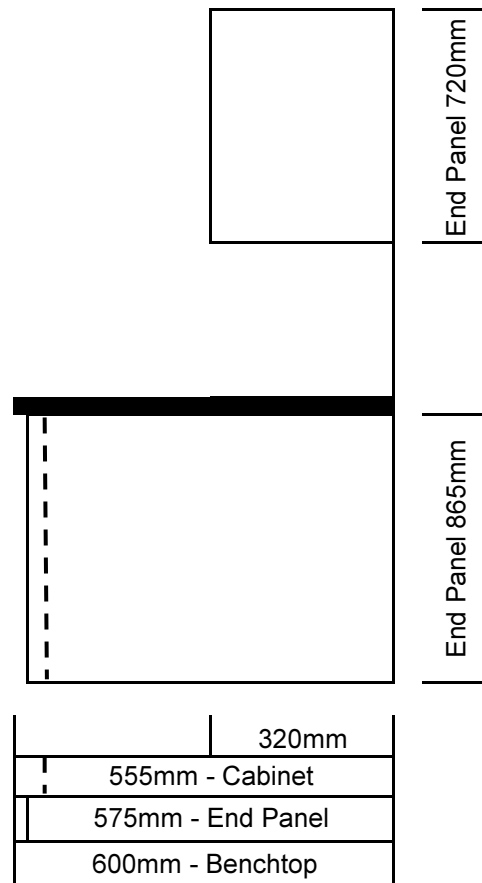

Instructions for fitting the HETTICH Korrekt Height Adjustable Legs.

Leg Block

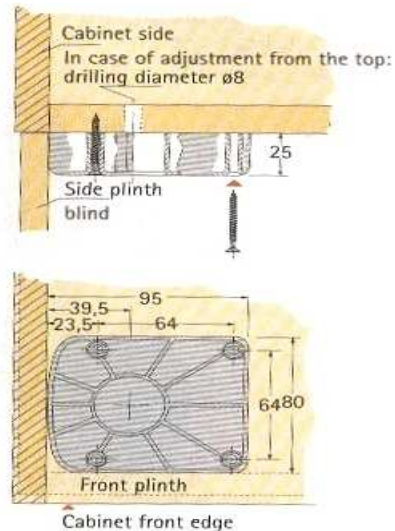

Adjustable Leg

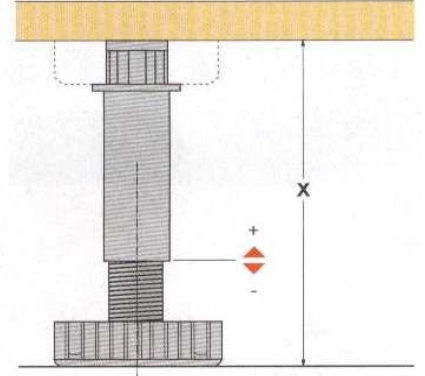

Clips



Each Leg Assembly Requires:

- 1 061 854 Leg Block (A)
 - 1 061 853 Adjustable Leg (B)
 - 1 "C" Clip (C)
 - 1 Adjustable Plinth Attachment (D)
- } 061 855
- 4 WBX40 Leg Block Screws 10 x 1-1/2 Pozidrive
 - 2 WBX06 Adjustable Plinth Attachment Screws 4 x 5/8 Pozidrive

Directions:

1. Locate Leg Block (A) as indicated on the diagram. Make sure Leg Block (A) is set back 50mm from the front edge and 1mm from the the side of the carcass.
Important Note: Set the Leg Block back 70mm on pantry units.
2. Fix Leg Block (A) with 4 x 10 x 1-1/2 pozidrive screws.
3. Slide C-Clip (C) onto Adjustable Plinth Attachment (D).
4. To determine the placement of the C-Clip and Attachment on the kick rail, first lay the kick rail face down on the floor against the adjustable leg and move to position you want it to finish.
5. Mark the location of the centre of the leg (s) which will receive the C-Clip.
6. Centre the adjustable slide attachment over the mark and fix using 2 - 4 x 5/8 pozidrive screws.
7. Tilt the kickrail towards the leg (s) and press until C-Clips engage.



YOUR DESIGN COULD LOOK SOMETHING LIKE THIS!

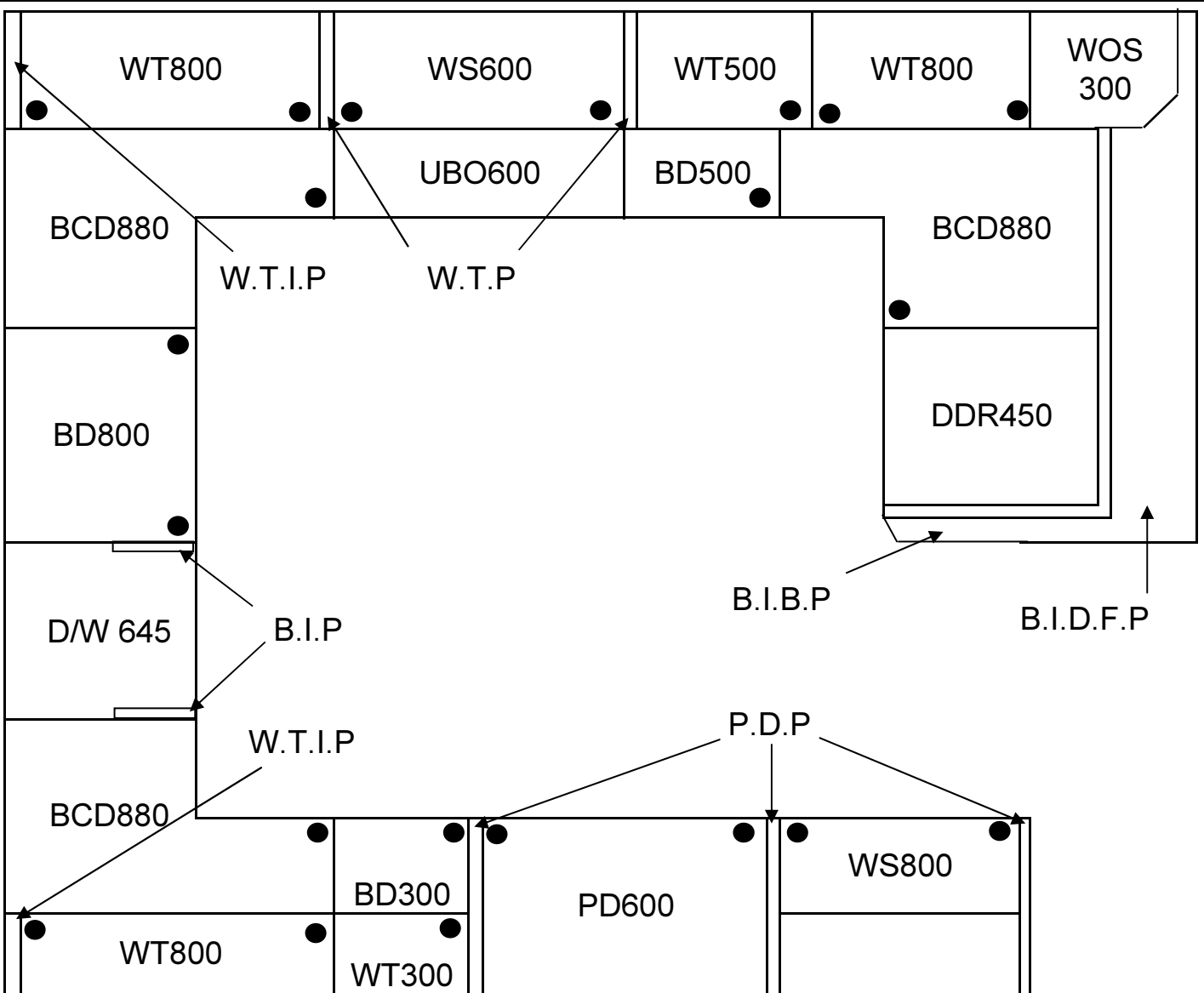

CABINET LIST

3 x BCD880	Base Corner Deep	1 x WT300	Wall Tall
1 x BD800	Base Deep	1 x WS600	Wall Small (Rangehood)
1 x BD500	Base Deep	1 x WS800	Wall Small (Rangehood)
1 x DDR450	Deep Drawer	3 x P.D.P	Pantry Deep Panel
1 x UBO600	Under Bench Oven	2 x W.T.P	Wall Tall Panel
1 x BD300	Base Deep	2 x W.T.I.P	Wall Tall Infill Panel
1 x PD600	Pantry Deep	1 x B.I.D.F.P	Base Island Deep Floor Panel
3 x WT800	Wall Tall	1 x B.I.B.P	Base Island Back Panel
1 x WT500	Wall Tall	2 x B.I.P	Infill Panel

Now you should have some understanding of all the elements of designing.
You can now start to put your dream kitchen together piece by piece.

If the whole process is too daunting to even think about, make an appointment with one of our kitchen designers and they will help and guide you through the whole process.

Please note that the contents of this manual are to be treated as a guide only.

If you have any further queries, please do not hesitate to contact our experienced staff at Home of Kitchens.



PH: 9793 4233

Fax: 9792 5046

E: info@homeofkitchens.com.au

W: www.homeofkitchens.com.au



HOME OF KITCHENS

222-224 Frankston-Dandenong Rd, DANDENONG STH VIC 3175

TELEPHONE: (03) 9793 4233

FAX: (03) 9794 0972

EMAIL: info@homeofkitchens.com.au

STARTING
POINT

6000mm (6m)

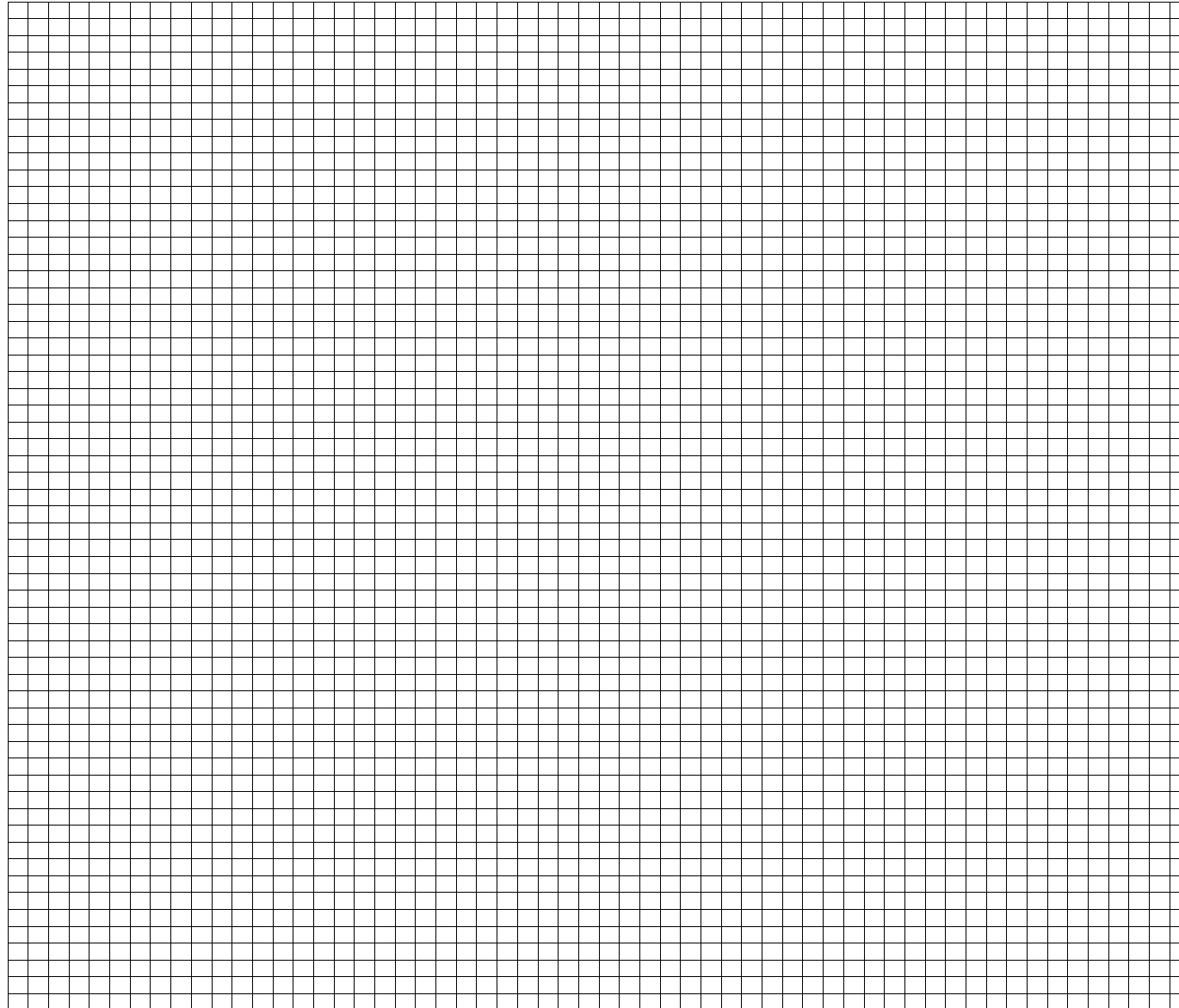

6000mm (6m)

DESIGN SHEET FOR: _____

CUSTOMER'S ADDRESS: _____

PHONE NUMBER: _____ WORK: _____

FAX: _____ DATE: _____

One Square = 100 x 100mm